

NPS Threads



New style with 7/8" thread depth = 10 threads for nozzle engagement

***Deeper threads • Longer body • Thicker walls • Stronger
(Aluminum & Brass)***

SIZES AVAILABLE: 1/2", 3/4", 1", 1-1/4", 1-1/2"

COMPONENTS: Aluminum • Brass • Nylon

WORKING PRESSURE: 150 PSI maximum recommended operating pressure

STANDARDS: 1-1/4 - 11-1/2 NPSM-2B Threads

DIMENSIONS

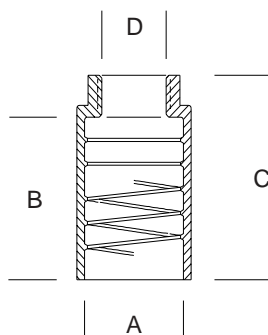

	A	B	C	D
Size	Hose OD	Hose Length	Length Overall	Thread
1/2"	1-3/16"	2-9/16"	3-1/4"	3/4" NPS
3/4"	1-1/2"	3"	3-7/8"	1-1/4" NPS
1"	1-7/8"	3"	3-7/8"	1-1/4" NPS
1-1/4"	2-5/32"	3-3/8"	4-1/4"	1-1/4" NPS
1-1/2"	2-3/8"	3-3/8"	4-1/4"	1-1/4" NPS